

SILVER HILL PLAZA

District Heights, MD 20747



PROJECT FACTS

GLA: 126,750 SF

- ▶ Community center featuring destination retailers for 'one stop' shopping convenience
- ▶ Located in one of the most densely populated areas of Prince George's County
- ▶ Within 1/2 mile of Pennsylvania Avenue
- ▶ Center boasts a signalized entrance on heavily traveled Silver Hill Road

FEATURED TENANTS

Shoppers Food, CVS/pharmacy

2024 DEMOGRAPHICS

	Population	Avg HH Income	Households
1 mile	20,241	\$88,431	8,803
3 mile	138,375	\$97,634	57,438
5 mile	371,745	\$102,713	151,791

2024 ESRI

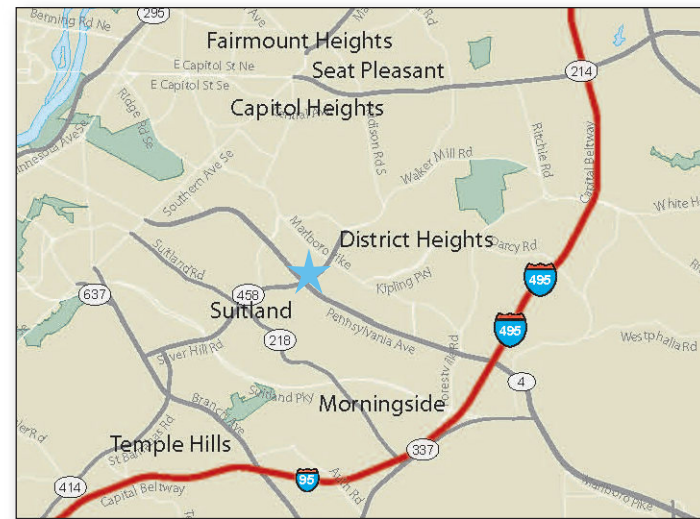

LOCATION

Silver Hill Road & Marlboro Pike - District Heights, MD

LEASING CONTACT

David Paik
202.736.2804 | DPaik@combined.biz



SILVER HILL PLAZA

DISTRICT HEIGHTS, MARYLAND

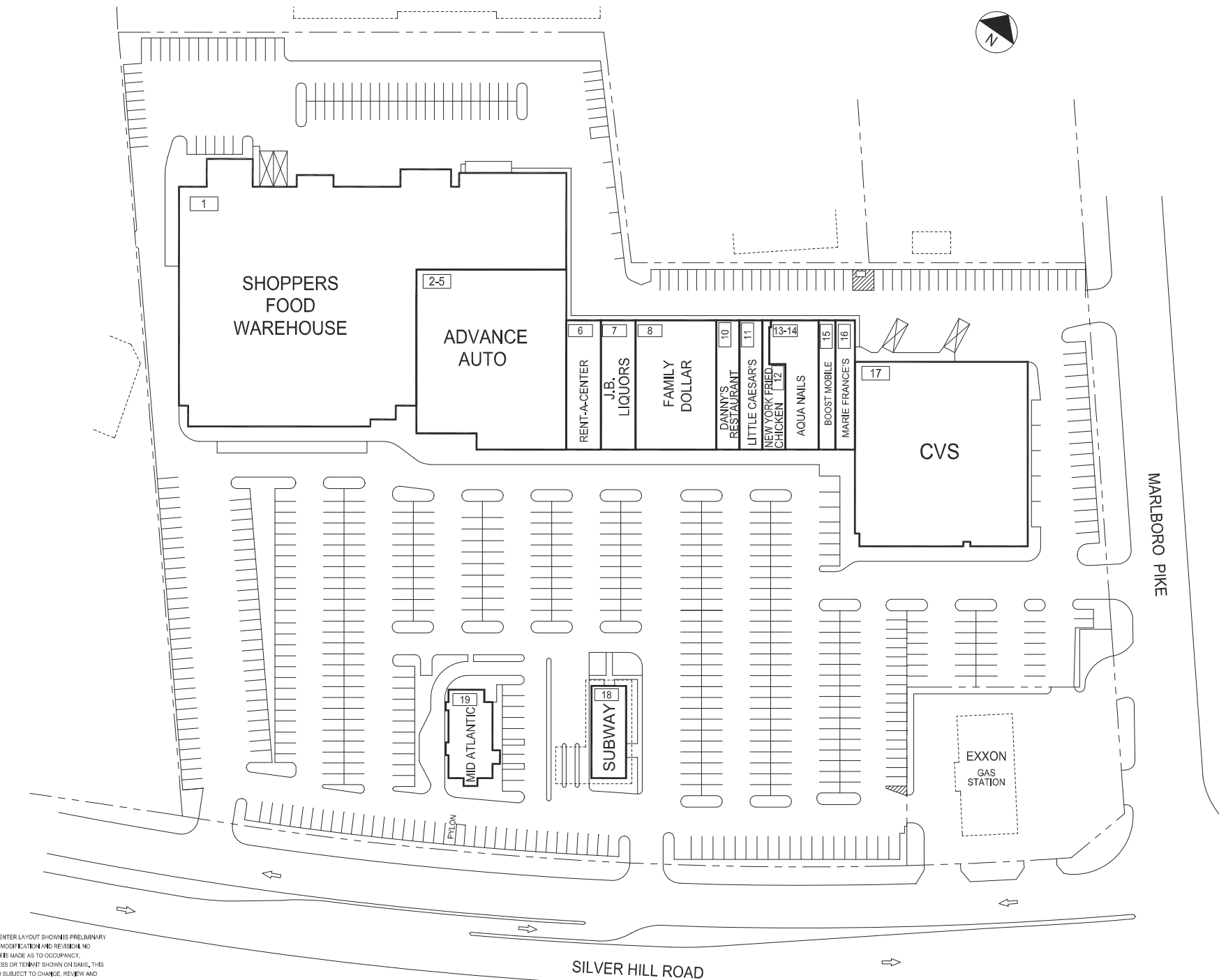

LEASING PLAN

THE SHOPPING CENTER LAYOUT SHOWN IS PRELIMINARY AND SUBJECT TO MODIFICATION AND REVISION. NO REPRESENTATION IS MADE AS TO OCCUPANCY. TYPES OF BUSINESS OR TENANT SHOWN ON SAME, THIS DRAWING IS ALSO SUBJECT TO CHANGE, REVIEW AND APPROVAL OF ALL GOVERNMENTAL AUTHORITIES. ADDITIONAL BUILDINGS OR STRUCTURES MAY BE ADDED OR DELETED AND EXISTING BUILDINGS OR STRUCTURES MAY BE REMOVED, DELETED OR OTHERWISE MODIFIED AND THE LANDSCAPING AND PARKING LAYOUT IS SUBJECT TO CHANGE.

50' 100'
APPROX. SCALE

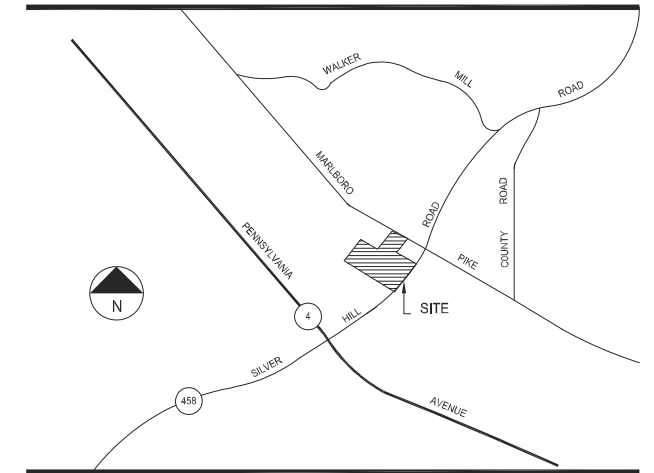

TENANT ROSTER

TENANT		AREA	SQ. FT.
1	SHOPPERS FOOD		51,828 SF
2-5	ADVANCE AUTO		19,008 SF
6	RENT-A-CENTER		3,300 SF
7	J.B. LIQUORS		3,300 SF
8	FAMILY DOLLAR		7,700 SF
10	DANNY'S RESTAURANT		2,200 SF
11	LITTLE CAESAR'S		2,200 SF
12	NEW YORK FRIED CHICKEN		1,250 SF
13-14	AQUA NAILS		2,880 SF
15	BOOST MOBILE		1,500 SF
16	MARIE FRANCE'S HAIR BRAIDING		1,880 SF
17	CVS		24,000 SF
FREESTANDING PAD BUILDINGS			
18	SUBWAY		2,534 SF
19	MID ATLANTIC SEAFOOD		3,000 SF
PARKING PROVIDED =			
PARKING REQUIRED =			
GLA AS PER RENT ROLL = 126,581 SF			
ZONED = C-2, CSC			
REV. DATE = APR 2024			

SILVER HILL PLAZA

SILVER HILL ROAD & MARLBORO PIKE
DISTRICT HEIGHTS, MARYLAND 20747



COMBINED PROPERTIES INCORPORATED

7315 Wisconsin Ave
Suite 1000 West
Bethesda, MD 20814
(202) 293-4500
FAX (202) 833-3013