

SILVER HILL PLAZA

DISTRICT HEIGHTS, MARYLAND

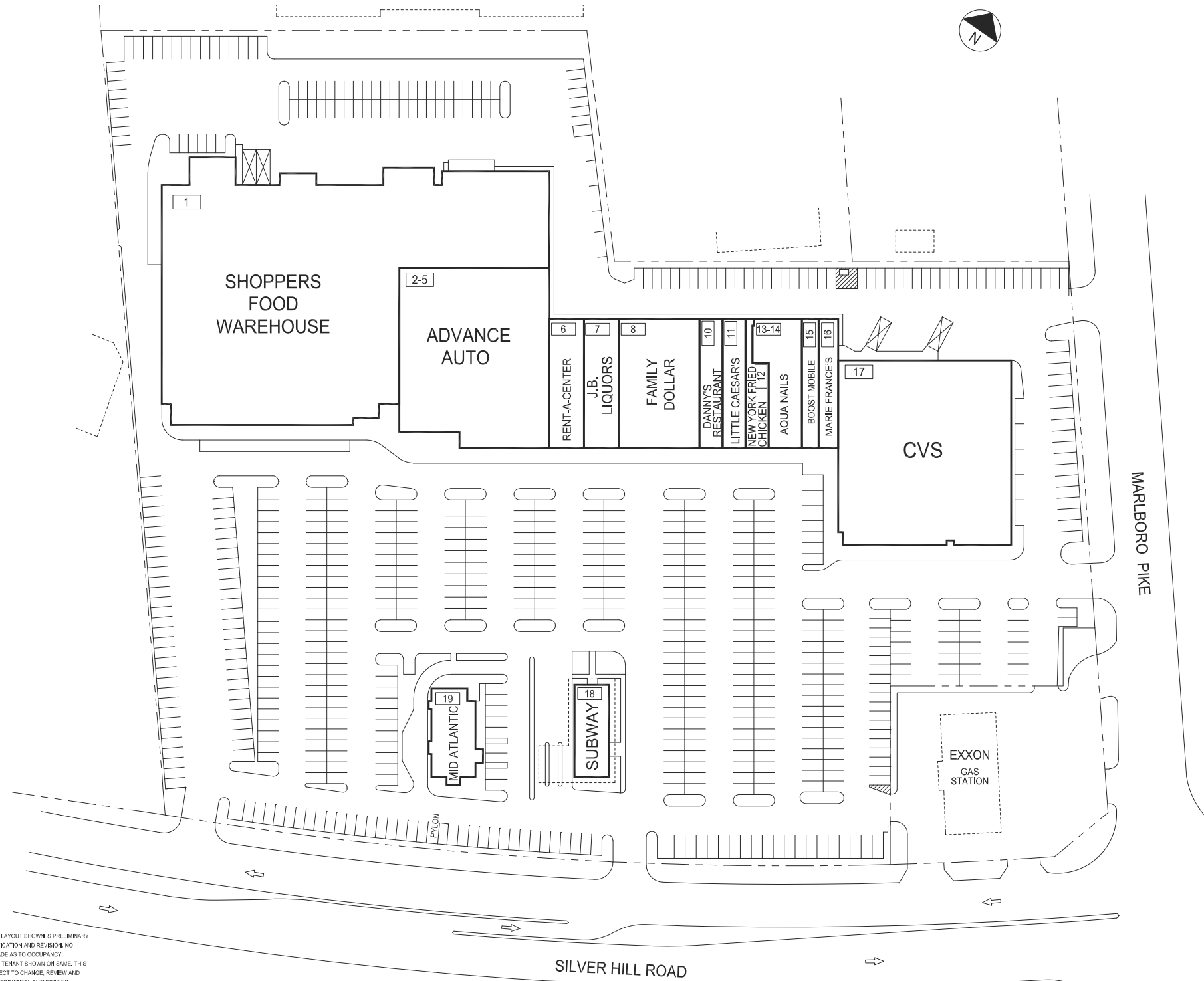

LEASING PLAN

THE SHOPPING CENTER LAYOUT SHOWN IS PRELIMINARY AND SUBJECT TO MODIFICATION AND REVISION. NO REPRESENTATION IS MADE AS TO OCCUPANCY. TYPES OF BUSINESS OR TENANT SHOWN ON SNAFL THIS DRAWING IS ALSO SUBJECT TO CHANGE. REVIEW AND APPROVAL OF ALL GOVERNMENTAL AUTHORITIES. ADDITIONAL BUILDINGS OR STRUCTURES MAY BE BUILT OR ADDED AND EXISTING BUILDINGS OR STRUCTURES MAY BE REMOVED, DELETED OR OTHERWISE MODIFIED AND THE LANDSCAPING AND PARKING LAYOUT IS SUBJECT TO CHANGE.

50' 100'
APPROX. SCALE

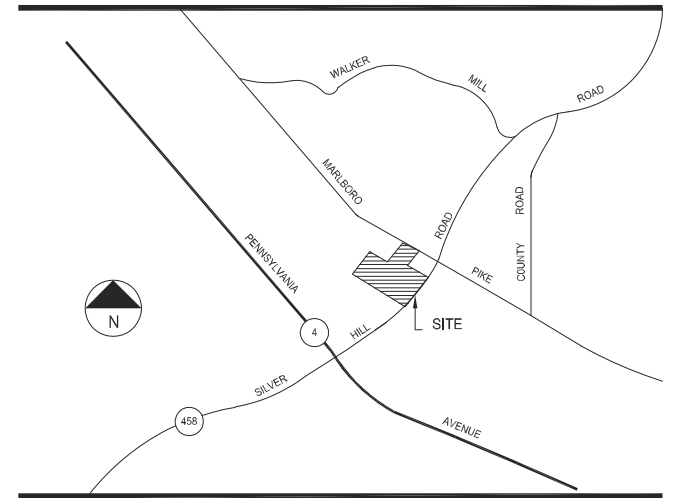

TENANT ROSTER

NO.	TENANT	SQ. FT.	TYPE	SQ. FT.
1	SHOPPERS FOOD	51,828	WAREHOUSE	
2-5	ADVANCE AUTO	19,008	WAREHOUSE	
6	RENT-A-CENTER	3,300	RETAIL	
7	J.B. LIQUORS	3,300	RETAIL	
8	FAMILY DOLLAR	7,700	RETAIL	
10	DANNY'S RESTAURANT	2,200	RETAIL	
11	LITTLE CAESAR'S	2,200	RETAIL	
12	NEW YORK FRIED CHICKEN	1,250	RETAIL	
13-14	AQUA NAILS	2,880	RETAIL	
15	BOOST MOBILE	1,500	RETAIL	
16	MARIE FRANCE'S HAIR BRAIDING	1,880	RETAIL	
17	CVS	24,000	RETAIL	
18	SUBWAY	2,534	RETAIL	
19	MID ATLANTIC SEAFOOD	3,000	RETAIL	

PARKING PROVIDED =
PARKING REQUIRED =
GLA AS PER RENT ROLL = 126,581 SF
ZONED = C-2, CSC
REV. DATE = APR 2024

SILVER HILL PLAZA

SILVER HILL ROAD & MARLBORO PIKE
DISTRICT HEIGHTS, MARYLAND 20747



COMBINED PROPERTIES INCORPORATED

7315 Wisconsin Ave
Suite 1000 West
Bethesda, MD 20814
(202) 293-4500
FAX (202) 833-3013