

# SILVER HILL PLAZA

District Heights, MD 20747



## PROJECT FACTS

**GLA: 126,750 SF**

- ▶ Community center featuring destination retailers for 'one stop' shopping convenience
- ▶ Located in one of the most densely populated areas of Prince George's County
- ▶ Within 1/2 mile of Pennsylvania Avenue
- ▶ Center boasts a signalized entrance on heavily traveled Silver Hill Road

## FEATURED TENANTS

Shoppers Food, CVS/pharmacy

## 2025 DEMOGRAPHICS

	Population	Avg HH Income	Households
1 mile	20,248	\$87,333	8,823
3 mile	138,654	\$98,685	57,960
5 mile	373,857	\$103,532	154,091

2025 ESRI

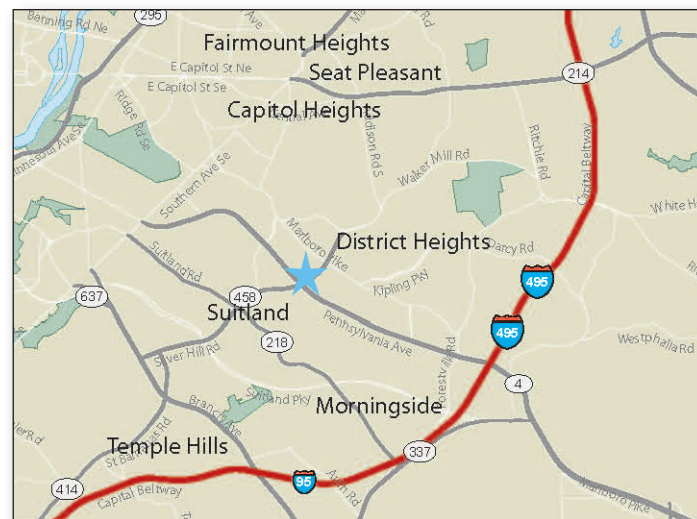

## LOCATION

Silver Hill Road & Marlboro Pike - District Heights, MD

## LEASING CONTACT

David Paik  
202.736.2804 | [DPaik@combined.biz](mailto:DPaik@combined.biz)



# SILVER HILL PLAZA

DISTRICT HEIGHTS, MARYLAND

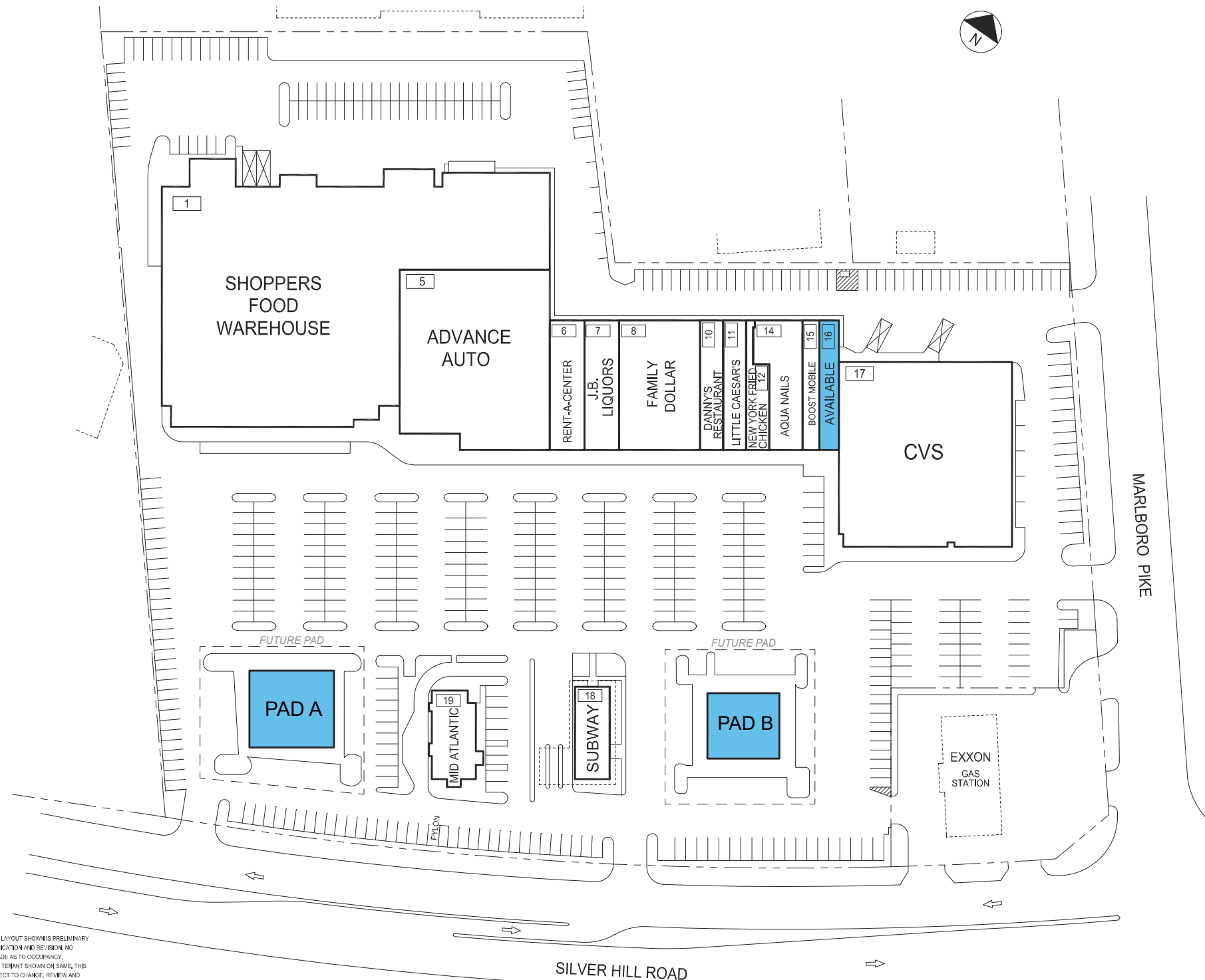

## LEASING PLAN

THE SHOPPING CENTER LAYOUT SHOWN IS PRELIMINARY AND SUBJECT TO MODIFICATION AND REVISION. NO REPRESENTATION IS MADE AS TO OCCUPANCY. TYPES OF BUSINESS OR TENANT SHOWN ON SMALL THIS DRAWING IS ALSO SUBJECT TO CHANGE. REVIEW AND APPROVAL OF ALL GOVERNMENTAL AUTHORITIES. ADDITIONAL BUILDINGS OR STRUCTURES MAY BE BUILT OR ADDED AND EXISTING BUILDINGS OR STRUCTURES MAY BE REMOVED, DELETED OR OTHERWISE MODIFIED AND THE LANDSCAPING AND PARKING LAYOUT IS SUBJECT TO CHANGE.

50' 100'  
APPROX. SCALE

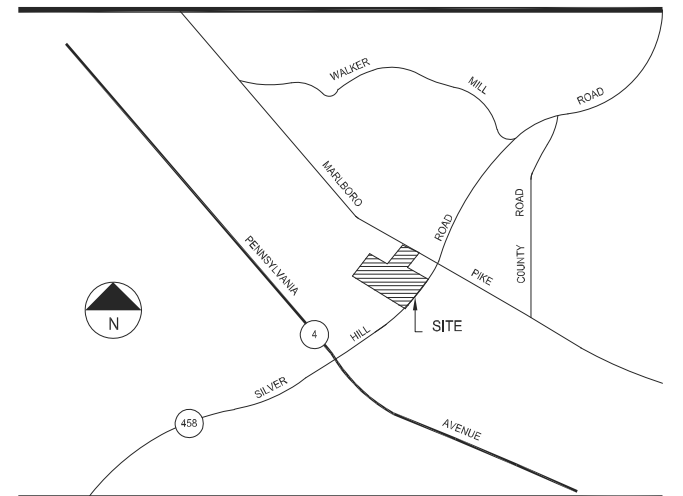

### TENANT ROSTER

ANCHOR TENANTS		FREESTANDING PAD BUILDINGS			
1	SHOPPERS FOOD	51,828 SF	18	SUBWAY	2,534 SF
5	ADVANCE AUTO	19,008 SF	19	MID ATLANTIC SEAFOOD	3,000 SF
6	RENT-A-CENTER	3,300 SF		PAD A FUTURE PAD	UP TO 4,200 SF
7	J.B. LIQUORS	3,300 SF		PAD B FUTURE PAD	UP TO 3,500 SF
8	FAMILY DOLLAR	7,700 SF			
10	DANNY'S RESTAURANT	2,200 SF			
11	LITTLE CAESAR'S	2,200 SF			
12	NEW YORK FRIED CHICKEN	1,250 SF			
14	AQUA NAILS	2,880 SF			
15	BOOST MOBILE	1,500 SF			
16	AVAILABLE	1,880 SF			
17	CVS	24,000 SF			

PARKING PROVIDED =  
PARKING REQUIRED =  
GLA AS PER RENT ROLL = 126,581 SF  
ZONED = C-2, CSC  
REV. DATE = APR 2026

## SILVER HILL PLAZA

SILVER HILL ROAD & MARLBORO PIKE  
DISTRICT HEIGHTS, MARYLAND 20747



COMBINED PROPERTIES INCORPORATED

7315 Wisconsin Ave  
Suite 1000 West  
Bethesda, MD 20814  
(202) 293-4500  
FAX (202) 833-3013